

# Application for a Competitive Network Connection

Suitable for;  
Request for connection installation by an ICP for adoption by WPD  
Request to connect an embedded network

On receipt of your application and all relevant information, we will provide you with a quotation for the works which will include costs for the non-contestable works and any agreed contestable works.

## Section A – Your Details

### 1. Customer address details

Please enter the details of the customer who will accept and pay for the Connection Offer

Title:                      First Name:                      Last Name:

Company (if applicable):                      Company Registered Number (if applicable):

House/flat number:    Building name:                      Street:

Town:                      City:                      Postcode:

Daytime Telephone:                      Mobile:                      Email:

### 2. Site address details

The location of the new connection(s)

Site name/plot numbers:

House/flat number:    Building name:                      Street:

Town:                      City:                      Postcode:

To help us locate your site please include the address of any adjacent properties:

### 3. Representative details

Please enter the details of any representative (contractor, supplier, agent) acting on behalf of the customer with their consent

Title:                      First Name:                      Last Name:

Company (if applicable):                      Company Registered Number (if applicable):

House/flat number:    Building name:                      Street:

Town:                      City:                      Postcode:

Daytime Telephone:                      Mobile:                      Email:

 **PROCEED TO SECTION B**

## Section B – Type of Connection Offer required

### Do you require an indicative Budget Estimate or a firm Connection Offer?

**Connection Offer:** A Connection Offer is a quotation which will set out detailed terms and conditions and once accepted will be binding on both parties.

**Budget Estimate:** A Budget Estimate is non-binding for indicative purposes only. This is useful at the early stages of a project, if you have not got final plans in place or a firm date in mind for the works.

**When would you like us to provide the connection(s)?**  
Once you accept the Connection Offer we will contact you to agree dates which take account of team availability and Local Authority streetworks requirements:

DD/MM/YY

 PROCEED TO SECTION C

## Section C – Responsibilities for Inclusion in the Connection Offer

To ensure we provide you with the most accurate quotation, it is important that we understand the extent to which you require services to be provided by WPD. Please indicate who will be undertaking each of the following activities:

### Design and self-approval of the POC to WPD's existing network

WPD      ICP

You must be signed up to WPD's Framework and POC Extension of Contestability Agreement and hold the relevant network design authorisations

### Design approval of downstream assets to be adopted by WPD

WPD      ICP

You must have achieved design self-approval

### Obtaining legals permissions and consents:

WPD      ICP

### Completion of energising connection to WPD's network:

WPD      ICP

### Ownership of the constructed network:

WPD      ICP

Please enter the IDNO name (if known)

 PROCEED TO SECTION D

## Section D – Type of Connections Required

### New Connections

#### Confirm the type of property requiring a new connection:

Installation of connections for adoption by WPD

Connection of an embedded (IDNO) network

Please enter the connections to be installed, including those to be adopted by an IDNO, in sections E and F below.

### Total Site Capacity

Please enter the total import and export capacity required

Import kVA    Export kVA

### Temporary Supply

#### Will a temporary supply be required?

Yes      No

#### Power requirement

Please enter your maximum power requirement of the temporary supply    kVA

#### Type of temporary supply

Single phase      Three phase

 PROCEED TO SECTION E

## Section E – Domestic Connections

How many connections are required?

**Power requirement:**

The normal maximum capacity for individual domestic properties is 15kVA. If you require a different maximum power for each property please enter the kVA value here

kVA

**Landlord supplies:**

Will any landlord's supplies be required?

Yes

No

Number of landlord supplies

**Power requirement:**

Please enter your maximum power requirement for each landlords supply in kVA

kVA

Do you require your connection to accommodate motors, welders, electric vehicles or other disturbing equipment?

Yes (Proceed to section G)

No (Proceed to section H)

 PROCEED TO SECTION F

## Section F – Business Premises

How many connections are required?

Maximum power requirement for each connection

kVA

Please enter your maximum business premises power requirement, after diversity is applied

kVA

If power requirements differ significantly between supplies please provide more details in **Section L** – Additional Information

If your enquiry is for an increase in power, please state the existing load

kVA

Power guidelines: An 80 amp single phase supply can provide up to 18kVA. A 100 amp three phase supply can provide up to 69kVA.

**Earthing**

Earthing for connections to be adopted by WPD. However, some methods of building do not allow this means of earthing, in particular multi-occupancy steel framed buildings. In such cases alternative earthing solutions can be provided by your electrical contractor.

Is your building steel framed and subdivided into units?

Yes

No

Do you require your connection to accommodate motors, welders, electric vehicles or other disturbing equipment?

Yes (Proceed to section G)

No (Proceed to section H)

 PROCEED TO SECTION G

**Section G – Disturbing Loads**

If you are connecting any electrical equipment which may cause a disturbance on the electricity system (e.g. motors, welders), please provide us with details. Note: upon assessment we may need more detailed information. If required, we will send you the appropriate data collection form for completion.

**Motors**

				Starting Current (Amps)	Number of starts per hour
Single phase	Three phase	Direct Online	Star Delta		

**Welders**

		Input voltage	Rating	Number of welds per minute
Single phase	Three phase			

**Do you require electric vehicle charging or heat pump installation?**

No Yes

Please enclose with this application a completed ENA Application for the Installation of Low Carbon Technologies, available to download at [www.westernpower.co.uk/EVHP](http://www.westernpower.co.uk/EVHP)

**Other potentially disturbing equipment** (please provide details)

 PROCEED TO SECTION H

**Section H – Details of Electrical Load**

**Space Heating:**

To help plan for your connection, please indicate below the fuel type to be used:

Gas	Electric (Storage & Direct)	Electric Boiler	Ground/Air Source Heat Pump	Other (please specify)
-----	-----------------------------	-----------------	-----------------------------	------------------------

 For electric boilers and heat pumps, please include the manufacturer's specification sheet.

\*Off-peak means the heating that can only operate during a pre-arranged time (usually 7 hours) in the range of hours 23:00-07:00 and is usually controlled by a time-switch.

For electric storage heating, kW total off-peak\* load is:

For electric direct heating, kW total load is:

**Water Heating:**

To help plan for your connection, please indicate below the fuel type to be used:

Gas	Electric (Storage & Direct)	Electric Boiler	Ground/Air Source Heat Pump	Other (please specify)
-----	-----------------------------	-----------------	-----------------------------	------------------------

**Electric showers:** Number of instantaneous showers Shower size (kW each)

 PROCEED TO SECTION I

## Section I – Generation

## Will there be any on site electricity generation?

Yes (please provide details below)

For ER G99 compliant installations, please enclose the relevant G99 application form with this application

No - proceed to section J

## Please indicate the type of generation you are installing

Solar panels

Wind

Battery storage

## Other

If other please specify:

Please provide the proposed generation capacity

kW

## Will the generators be capable of operating in parallel with WPD's system?

Yes

No

Please visit our website for more information on connecting electricity generation  
[www.westernpower.co.uk/Connections/Generation](http://www.westernpower.co.uk/Connections/Generation)

 PROCEED TO SECTION J

## Section J – Build out programme

We require your proposed build out programme for the development. Please indicate the number and type of connections to be constructed each year and the associated capacity.

Note: if your development is proposed to take longer than 5 years to construct, please enter the details in Section L - Additional Information.

Number of domestic premises

Number of business premises

Annual capacity requirement (kVA)

Year 1

Year 2

Year 3

Year 4

Year 5

Should you wish to provide any further information regarding your build out programme, please enter below.

 PROCEED TO SECTION K

## Section K – Site Plans

In order to provide a Connection offer, we require one copy of the Location Plan and one copy of the Site Layout Plan, together with your application form.

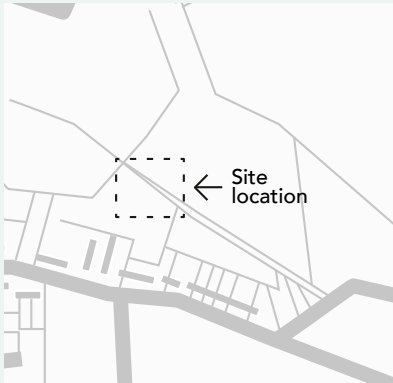

### Location Plan

The Location Plan shows where to find the proposed site for the new connection. All applications should have one Location Plan enclosed. Please highlight the site location on the plan.

Location plans can be obtained by using A-Z street maps or via the internet, which is now available in most public libraries.

The following sites offer instant Location Plans:

- [www.multimap.com](http://www.multimap.com)
- [www.ordsvy.gov.uk](http://www.ordsvy.gov.uk)

### Site Layout Plan

1. In the absence of an architect's drawing, please draw on a separate sheet a layout showing all the proposed buildings and accesses onto the site.
2. The proposed meter position(s) should be marked onto the plan with an X.

\*For embedded networks, the plan should include the proposed Point(s) of Supply locations

## Section L – Additional Information

Please provide any additional information you feel may be relevant to your connection application:

Please send your completed application form with supporting documentation to your regional office:

### Midlands

Western Power Distribution  
Records Team  
3rd Floor  
Toll End Road  
Tipton  
DY4 0HH

**T: 0121 623 9007**

(Lines are open Mon to Fri, 8:30 to 5pm)  
[wpdnewsuppliesmidlands@westernpower.co.uk](mailto:wpdnewsuppliesmidlands@westernpower.co.uk)

### South Wales

Western Power Distribution  
Records Team  
Phoenix Way  
Llansamlet  
Swansea  
SA7 9HW

**T: 0179 278 4509**

(Lines are open Mon to Fri, 8:30 to 5pm)  
[wpdnewsupplieswales@westernpower.co.uk](mailto:wpdnewsupplieswales@westernpower.co.uk)

### South West

Western Power Distribution  
Records Team  
Lostwithiel Road  
Bodmin  
PL31 1DE

**T: 0120 889 2288**

(Lines are open Mon to Fri, 8:30 to 5pm)  
[wpdnewsupplies@westernpower.co.uk](mailto:wpdnewsupplies@westernpower.co.uk)

**!**  
**Important**

To prevent your application from being delayed, please ensure you have enclosed all the required information.

- ✓ **Completed application form**

✓ **Location plan**

✓ **Site layout plan**
- ✓ **Manufacturer's specification sheet**  
(if you are installing electric boilers, heat pumps, generation, or similar electrical equipment)

### What happens next?

#### Western Power Distribution:

#### Customer:

